

Flanschverschraubungen
Flange boltings
Boulonnerie de fixation

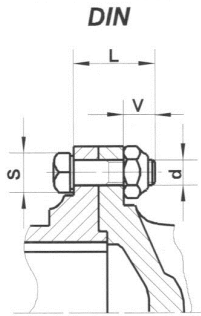

Sechskantschraube:
Kurzausführung ähnlich
DIN 931 / 10.9
Sechskantmutter:
ähnlich DIN 980 / 10
selbstsichernd

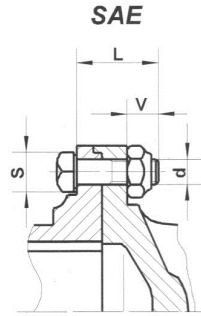

Hexagon bolt:
short model similar to
DIN 931 / 10.9
Hexagon nut:
similar to DIN 980 / 10
self-locking

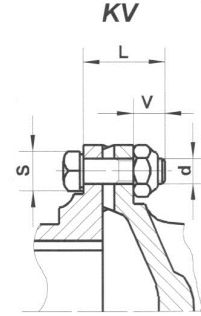

Vis hexagonale
exécution courte similaire à
DIN 931 / 10.9
Ecrou hexagonal
similaire à DIN 980 / 10
auto freiné

DIN											
A	mm	90	100	120	150	165	180	180	225	250	
Ta	Nm	35	35	69	120	295	190	295	295	405	
d		M 8	M 8	M 10	M 12	M 16	M 14	M 16	M 16	M 18	
L	mm	23	23	27	33	42	40	50	50	6075	
V	mm	11	9	11	13	18	16	22	20	17	
S	mm	13	13	17	19	24	22	24	24	27	
I		4	6	8	8	8	8	10	8	8	

SAE											
A	mm	87,3	96,8	115,9	151	174,6	203,2	203,2			
Ta	Nm	35	70	120	190	70	70	80			
d		M 8	M 10	M 12	M 14	M 10	M 10	M 11			
L	mm	25	26	35	45	31	31	34			
V	mm	13	12	19	25	12	9	12			
S	mm	13	17	19	22	17	17	19			
I		4	4	4	4	8	12	12			

KV											
A	Nm	120	150	180							
Ta	mm	70	120	190							
d	mm	M 10	M 12	M 14							
L	mm	35	45	50							
V	mm	11	17	18							
S	mm	17	19	22							
I		4	4	4							

A = Flansch-Ø / Flange-Ø / Ø de la bride
 Ta = Anzugsmoment / Tightening torque / Couple de serrage
 I = Anzahl Flanschbohrungen / Number of bolt holes / Nombre de trous